

Illustrated Index

Torque Converter Housing

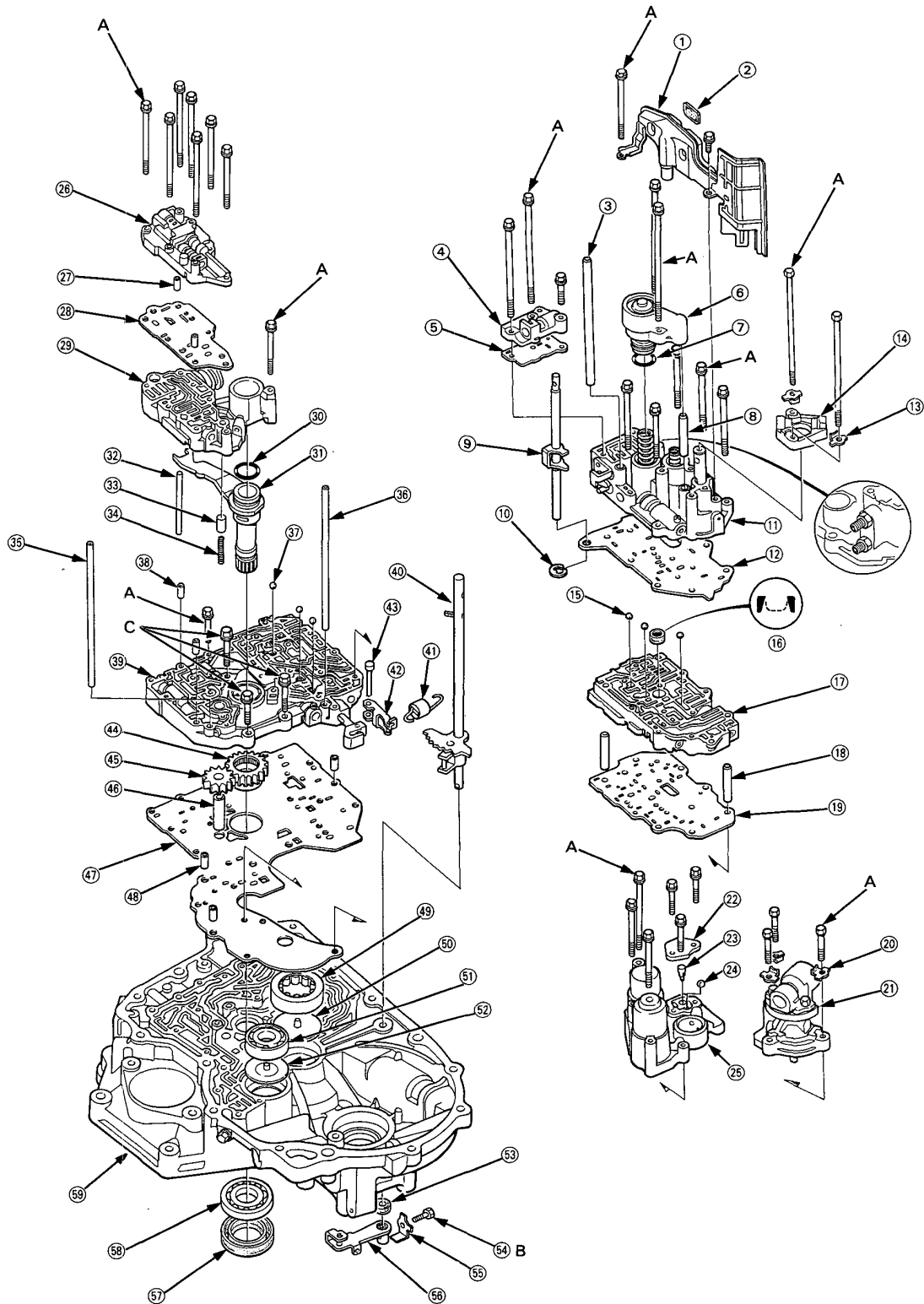



- | | |
|-----------------------------|--|
| ① ATF STRAINER | ③② STOPPER PIN |
| ② MAGNET | ③③ TORQUE CONVERTER CHECK VALVE |
| ③ OIL FEED PIPE | ③④ TORQUE CONVERTER CHECK VALVE SPRING |
| ④ MODULATOR VALVE BODY | ③⑤ OIL FEED PIPE |
| ⑤ MODULATOR SEPARATOR PLATE | ③⑥ OIL FEED PIPE |
| ⑥ 4TH ACCUMULATOR COVER | ③⑦ CHECK BALL |
| ⑦ O-RING Replace. | ③⑧ DOWEL PIN |
| ⑧ OIL FEED PIPE | ③⑨ MAIN VALVE BODY |
| ⑨ THROTTLE CONTROL SHAFT | ④① CONTROL SHAFT ASSEMBLY |
| ⑩ E-RING Replace. | ④② DETENT SPRING |
| ⑪ SERVO BODY | ④③ DETENT ARM |
| ⑫ SERVO SEPARATOR PLATE | ④④ DETENT ARM SHAFT |
| ⑬ LOCK WASHER Replace. | ④⑤ OIL PUMP DRIVE GEAR |
| ⑭ SERVO DETENT BASE | ④⑥ OIL PUMP DRIVEN GEAR |
| ⑮ CHECK BALL | ④⑦ OIL PUMP DRIVEN GEAR SHAFT |
| ⑯ FILTER Replace. | ④⑧ MAIN SEPARATOR PLATE |
| ⑰ SECONDARY VALVE BODY | ④⑨ DOWEL PIN |
| ⑱ DOWEL PIN | ④⑩ COUNTERSHAFT NEEDLE BEARING |
| ⑲ SECONDARY SEPARATOR PLATE | ⑤① OIL GUIDE PLATE Replace. |
| ⑳ LOCK WASHER Replace. | ⑤② SECONDARY SHAFT BALL BEARING |
| ㉑ GOVERNOR BODY | ⑤③ OIL GUIDE PLATE Replace. |
| ㉒ ACCUMULATOR BODY COVER | ⑤④ OIL SEAL Replace. |
| ㉓ 1ST ACCUMULATOR CHOKE | ⑤⑤ SPECIAL BOLT |
| ㉔ STEEL BALL | ⑤⑥ LOCK WASHER Replace. |
| ㉕ 1ST/2ND ACCUMULATOR BODY | ⑤⑦ CONTROL LEVER |
| ㉖ THROTTLE VALVE BODY | ⑤⑧ OIL SEAL Replace. |
| ㉗ DOWEL PIN | ⑤⑨ MAINSHAFT BALL BEARING |
| ㉘ THROTTLE SEPARATOR PLATE | ⑤⑩ TORQUE CONVERTER HOUSING |
| ㉙ REGULATOR VALVE BODY | |
| ㉚ O-RING Replace. | |
| ㉛ STATOR SHAFT | |

TORQUE SPECIFICATIONS

Ref. No.	Torque Value	Bolt Size	Remarks
A	12 N·m (1.2 kg-m, 9 lb-ft)	6 × 1.0 mm	
B	14 N·m (1.4 kg-m, 10 lb-ft)	6 × 1.0 mm	
C	18 N·m (1.8 kg-m, 13 lb-ft)	8 × 1.25 mm	